

Operating Instructions:

Power On/Off and Changing Modes:

- All features of your new Vision Series will be accessed through the included remote control.
- To turn your light on/off, press the red button on the top left of your remote control as indicated in the image to the right.
- This light has 64 levels of variable light output that can be selected via the red “-” and “+” buttons on the remote control. Alternatively, there are shortcuts on the remote control for 100%, 80%, 60%, 40%, 20%, and 10% outputs.
- Remote control is powered by a CR2032 battery. Battery life is typically 1 – 2 years. Your Vision Series will not function properly and may not turn on or off when battery needs replacement.

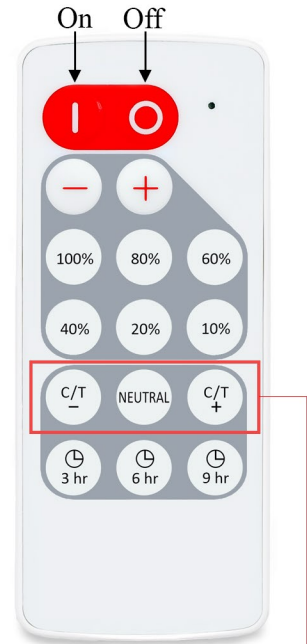

*Color Tuning Models Only

Color Tuning Models ONLY:

- To use the Color Tuning buttons, you can press the “C/T -” button to shift your light one step warmer in the 7 step range. Pressing the “C/T +” button will shift your light one step cooler in the 7 step range. The Neutral button will bring your light to the middle of these 7 steps, approximately 3300K.

Installation Instructions:

*Test fixture prior to installation.

Tools required: Screwdriver, drill (optional for wall mount), hammer (optional), pencil, level, and tape.

Mounting to Artwork

1. Remove artwork from wall.
2. Locate, then mark top center of artwork with a pencil.
3. Locate the Vision Series Mounting Template provided which fits your model (17”, 30”, 43”, or 56”). If needed, fold or cut the mounting template to your selected size.
4. Tape the selected template to the back of your artwork with the centerline matched to the center mark on your artwork. Ideally, the long horizontal line with the indicated screw holes should be ½” - 1” below the top of your frame. With a sharp object or pencil, mark the screw holes in the brackets (2 per bracket).
5. Align the mounting bracket with the marked holes and attach with 4 short black screws provided. Take care that once the screw is installed, it will not damage the artwork. Drilling a pilot hole is recommended, though may not be required. Do not worry if mounting brackets are not completely level with one another; Adjustments in step 6 can make up for slight differences.
6. Unfold the arms of the Vision Series 90°. Do not tighten or attempt to tighten the arms. Guide the two arms into the slots of the mounting brackets and tighten with the included allen wrench. Height of the light is subjective and should be adjusted as desired. Raising the light can help eliminate glare.
7. Connect the included power supply to the LED Controller attached to the light. An extension cord is included; use if needed.
8. Remove protective caps and tape from light bar. Use remote control to dim as desired. Reattach artwork to wall and enjoy!



SEE REVERSE SIDE FOR OTHER MOUNTING OPTION

Wall Mount (recommended)

1. Using a pencil, mark your wall at center and top of your artwork.
2. Remove artwork from wall.
3. Locate the Vision Series Mounting Template provided which fits your model (17", 30", 43", or 56"). If needed, fold or cut the mounting template to your selected size.
4. Using a level, tape the selected template to the wall with the centerline matched to the center mark made on your wall. Ideally, the long horizontal line with the indicated screw holes should be $\frac{1}{2}$ " - 1" below the mark previously drawn. With a sharp object or pencil, mark the screw holes in the brackets. (2 per bracket) Do not worry if mounting blocks are not completely level with one another; Adjustments in step 7 can make up for slight differences.
5. Drill through the 4 holes using a 3/16" bit. Place a dry wall anchor (included) in each hole then attach the mounting bracket with the two long silver screws.
6. Unfold the arms of the Vision Series 90°. Do not tighten or attempt to tighten the arms. Guide the two arms into the slots of the mounting brackets and tighten with the included allen wrench. Height of the light is subjective and should be adjusted as desired. Raising the light can help eliminate glare.
7. Connect the included power supply to the LED Controller attached to the light. An extension cord is included; use if needed.
8. Remove protective caps and tape from light bar. Use remote control to dim as desired. Reattach artwork to wall and enjoy!

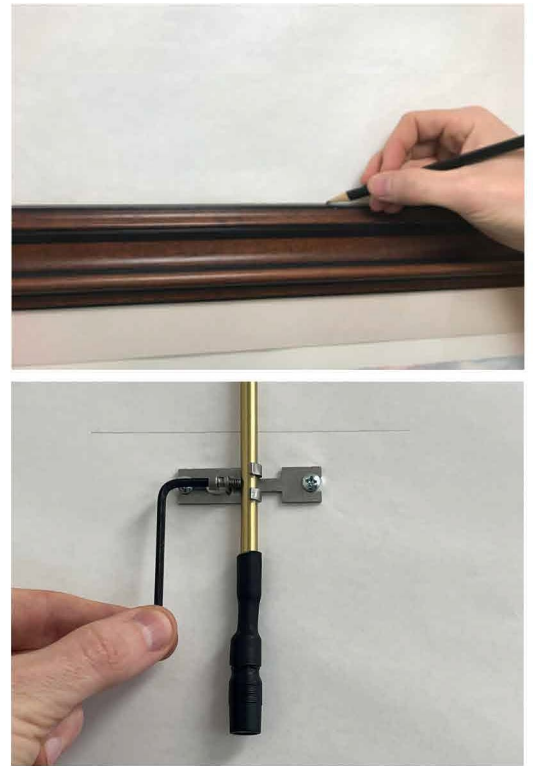

Body Adjustment:

- Once mounted, the body of the light can be pivoted to better align the light output to your artwork.
- We recommend adjusting the body of the fixture so that the beam of light begins at the top of your artwork (not the frame).

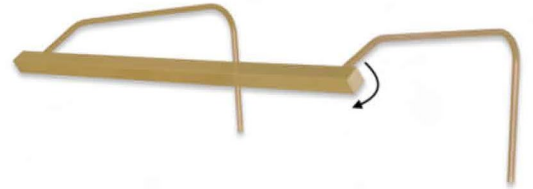

Programming Remote Control to Operate Additional Lights:

- 1) Unplug the power into the LED Controller (small white box) for 5 or more seconds.
- 2) Reconnect power then immediately press and hold the 100% and 60% buttons simultaneously for 1 second.
- 3) The remote is now programmed to the new light.
- 4) Repeat the process as necessary to continue programming the remote control to other lights.

OPERATING WARNINGS:

- Clean light fixture using a soft, dry cloth. Never use chemicals on or near your light fixture.
- AVOID EYE INJURY - Do not stare directly into beam or shine it directly into anyone's face.
- Never connect the light to any item other than the supplied power supply. Doing so may damage the product and void your warranty, and could possibly result in fire, electric shock or other bodily injury.
- Use in a dry and safe location. Our products are meant for indoor and dry locations only.
- Inspect your light carefully before use. Product can become damaged in shipping. Contact us if you have any of the following signs of a defective product: cuts or damage to electrical cord, damage to light head, or signs of damage on any part of the product.

PRECAUTIONS:

- Never try to disassemble, repair, or modify the power supply or this light. Electric shock may result. Contact us for warranty and repairs.
- If the plug will not fit into the available outlet, have a proper outlet installed by a qualified electrician. Trying to plug into an improper outlet can result in shock.
- Never allow liquids to spill on the power supply or the light and do not connect outdoors, as the unit is not waterproof. Exposure to rain or other liquid could result in fire or electric shock.
- Never use a power supply with a damaged or worn power cord or plug. This could result in electric shock, burns, or fire. Contact us to obtain a replacement.

PROTECTION OF CHILDREN:

- This product is not designed, intended or recommended for children.
- Never allow children to play with, or otherwise handle or operate, the light, its remote control, power supply, extension cord, or packaging, as injury to themselves or others could result.
- Keep all mounting accessories and components out of the reach of small children. Small parts, in particular, might present a choking hazard.